

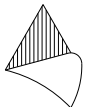

National Account Package Engineering  
engsupport@victorypackaging.com  
www.victorypackaging.com

CUSTOMER:	Kimball Electronics	ID:	22+1/16 x 17 x 0	ENGINEER:	Carlos Salinas	DESIGN #:	<b>D12968067</b>	<b>0</b>
ITEM:	RAWKIM-KCM16491-TB PAD	BLANK SIZE:	17 x 22+1/16	SALES REP:	Luis Co	DR #:	M193-00558	
CUST PROD. #:	KCM16491	SQ FT:	2.6	JOINT:	None	PRINT DATE:	11/15/2019	
STYLE:	SCORE PAD	WASTE (%):	0	CORR DIRECTION:	Vertical	VIEW:	outside	
MATERIAL:	32 ECT C Kraft	RULE TOTAL IN:	100+3/16	PROJECT NAME:	M193-00558 KIMBAL			
MATERIAL NOTES:				GENERAL NOTES:				

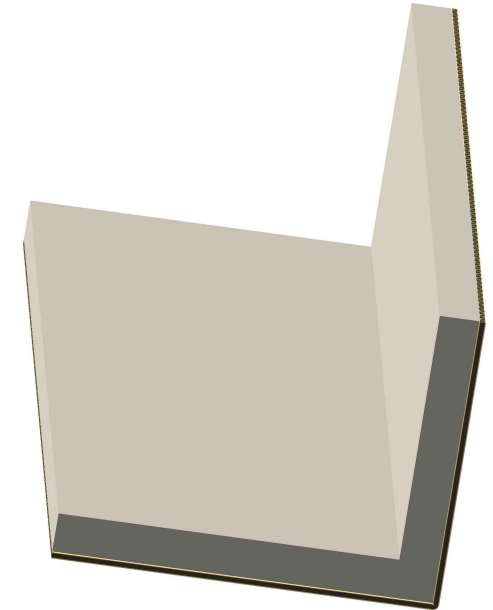
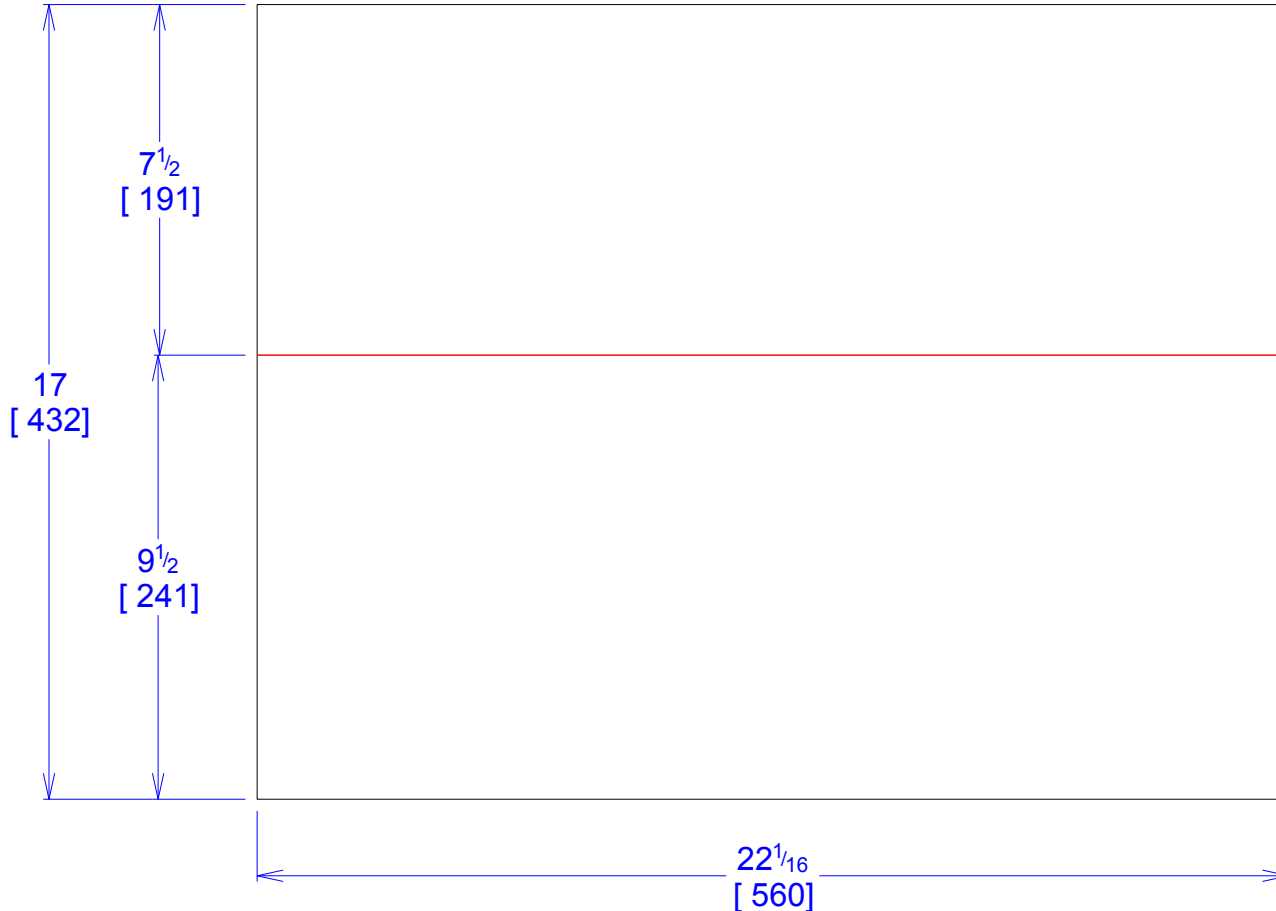

Vertical Corrugation

Print Status:	Plain
Colors:	

General Tolerances unless otherwise noted:			
Die Cut Corrugated Flat:	+/- 1/16	Pad/Block location:	+/- 1/8
Die Cut Corrugated Rotary:	+/- 3/16	Pad/Sheet:	+/- 1/8
		Wood Block:	+/- 1/4
		Foam Block:	+/- 3/16

Specification Release  
Approved for Production:

**Yes**