

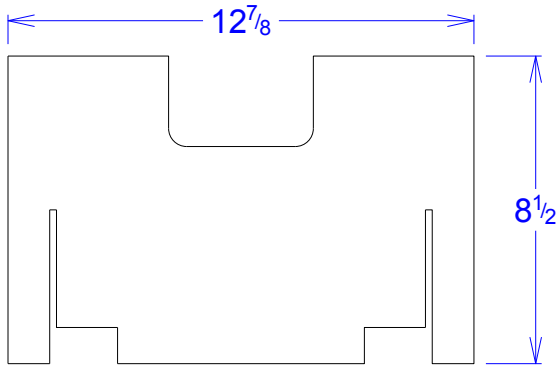

National Account Package Engineering
engsupport@victorypackaging.com
www.victorypackaging.com

CUSTOMER:	APTIV	Overall Size:	21+3/8 x 12+7/8 x 8+1/2	ENGINEER:	Carlos Gonzalez	DESIGN #:	D12970981	0
ITEM:	DDE28719826			SALES REP:	Lisa Mcririe	DR #:	M194-00025	
CUST PROD. #:				JOINT:	Assembly	PRINT DATE:	06/18/2020	
STYLE:	PTN			CORR DIRECTION:	Vertical	VIEW:	outside	
MATERIAL:	Other - see material note			KIT:	M194-00025 Aptiv			
MATERIAL NOTES:				GENERAL NOTES:				

C44ECT x 10



C44ECT x 2

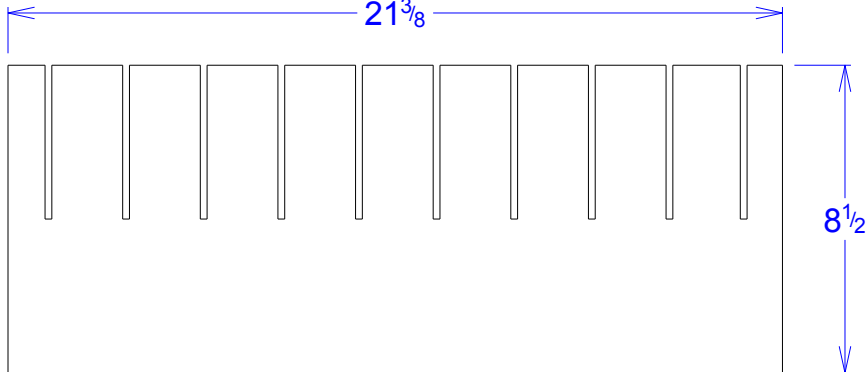

C32ECT x 1

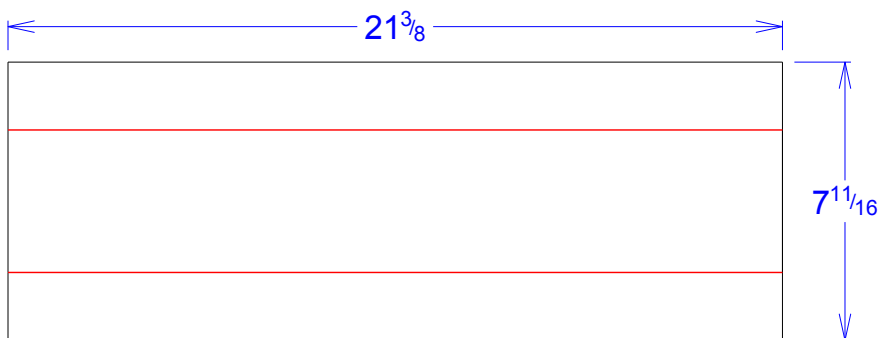

Isometric View

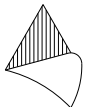
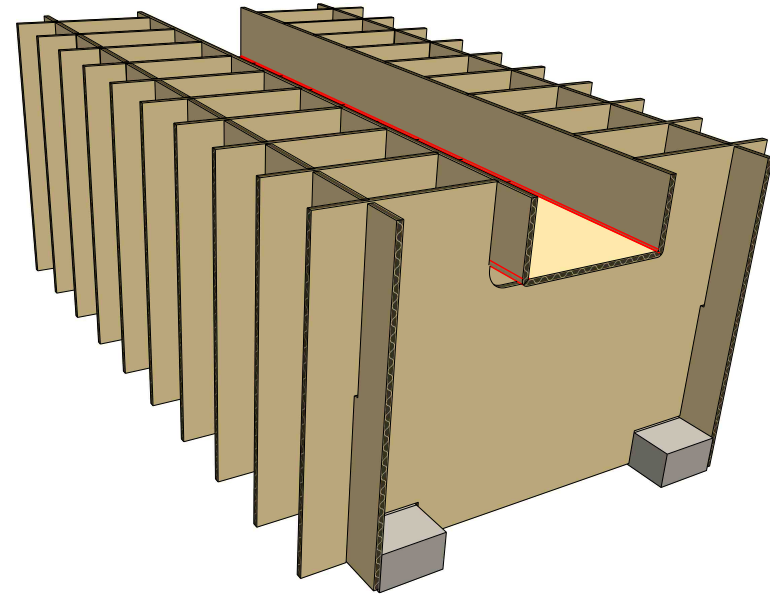

Vertical Corrugation

Print Status:	Plain
Colors:	

General Tolerances unless otherwise noted:

Die Cut Corrugated Flat:	+/- 1/16	Pad/Block location:	+/- 1/8	Wood Block:	+/- 1/4
Die Cut Corrugated Rotary:	+/- 3/16	Pad/Sheet:	+/- 1/8	Foam Block:	+/- 3/16

Specification Release
Approved for Production:

Yes